



Flabber Floovers™

Pulley™



A • Push ring up through the opening in bar (1).

Pass ring over the ball from behind (2), then back down through the opening in the bar and onto the end of the bar (3).

NOTE: MAKE CERTAIN THAT THE CORD IS ON THE RIGHT OF THE BALL, AS SHOWN.

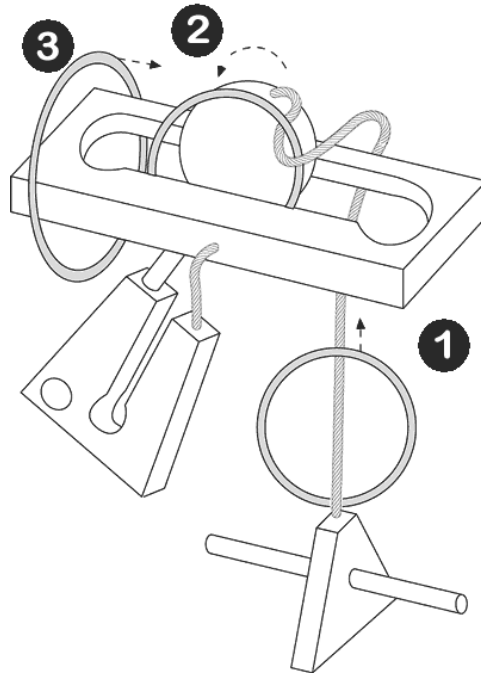

B • Slide the ring to the end of the bar and down the cord towards the block (4).

Follow the curve of the block (5), up through the opening in the bar (6), and over the ball. The ring is now free.

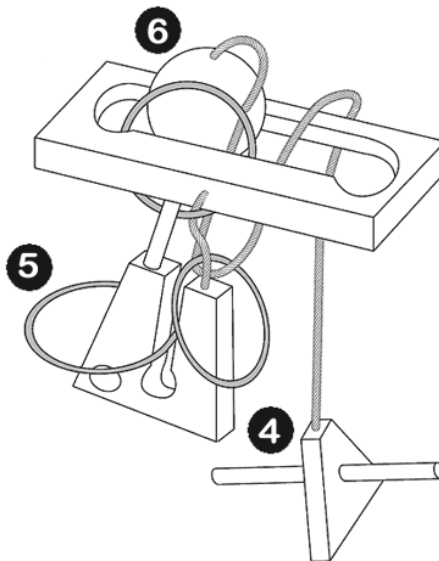

Available Puzzles

Clench
Abacus
Duress
Gripper
Shackle
Yank
Dipper
Weaver
Owl
Pulley
Granville
Labyrinth

Difficulty level **3 - Hard**

Manufactured and distributed by:

Family Games America FGA Inc. Montreal, Quebec, Canada www.familygamesamerica.com

Under license from Family Games America FGA Inc. © 1999 - 2005